

# Fastening Systems for Atlas Wall CI Board Continuous Insulation



## Thermal-Grip® ci Prong washers & Grip-Deck® screws



**Pre-spotting  
prongs for on-the-  
wall  
screw assembly**

**EZ-driver  
prevents screw  
wobble &  
overdrive**

**Grip-Deck®  
ceramic coated  
screws for  
corrosion  
protection**

**Solid Cap Design  
helps seal out air  
and moisture**

- 2" diameter
- Carbon black UV stabilizers
- Flattens on surface of insulation
- Compatible with nails and screws
- Specified for use with Atlas Wall CI Board



## Grip-Lok® Auto-feed fastening system with Bullseye® adaptor

**Bullseye® centers  
tool for rapid  
attachment**

**Significantly  
reduces installed  
labor costs**

**Adjustable depth  
control prevents  
overdrive**

**Manufacture  
tested,  
recommended,  
and approved**



- Available with 18V Li-ion battery or corded
- Bullseye® adaptor has magnets for use with Grip-Plate® lath washer
- For use with up to 3" long Grip-Deck® screws



**Plasti-Grip® PMF**  
For concrete/masonry substrates



**Easy Installation**

**Pre-drill with  
5/16" masonry bit**

**Tap flush with  
hammer**

**Prevents thermal-  
bridging**

**No screws or  
adhesives required**

- 2" PMF for insulation thickness of 1/2"-3/4"
- 2 3/4" PMF for insulation thickness of 1" - 1 1/2"
- 3 1/2" PMF for insulation thickness of 1 1/2" - 2"
- 4 1/2" PMF for insulation thickness of 2 1/2" - 3"
- 5 3/8" PMF for insulation thickness of 3 1/2" - 4"
- 6 1/4" PMF for insulation thickness of 4 1/4" - 5"



**Thermal-Grip®**  
washers for barrel-style brick-ties

**For use with  
Pos-I-Tie® or  
other barrel style  
vener anchors**

**Solid Cap Design  
helps seal out air  
and moisture**

**Reduces number  
of fasteners  
required**

**Use Thermal-  
Clip® with Pintle  
Wire Tie to create**

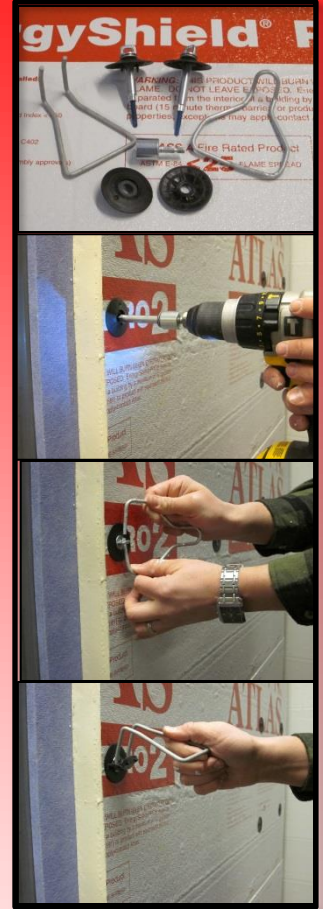

- Available with Triangle or Pintle style ties
- Self-drilling screw tip for steel studs or coarse screw tip for wood/masonry applications
- Specified for use with Atlas Wall CI Board

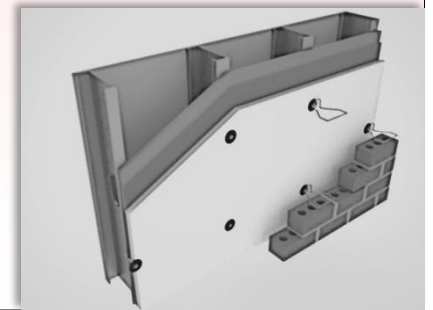

974 Front NW #100  
Grand Rapids, MI 49504  
1- 800-249-4747  
(T) 616-454-3100  
(F) 616-454-0404

[gripline@rodenhouse-inc.com](mailto:gripline@rodenhouse-inc.com)  
[www.rodenhouse-inc.com](http://www.rodenhouse-inc.com)

\*patented or patent pending



Atlas Roofing Corporation  
2000 RiverEdge Parkway,  
Suite 800  
Atlanta, GA 30328  
(T) 800-388-6134  
(F) 770-952-3170

[www.AtlasWallCi.com](http://www.AtlasWallCi.com)